

Module : Foreign language

Exam correction of 2nd semester

1- What are the five stages of construction management? Complete the diagram(7pts)

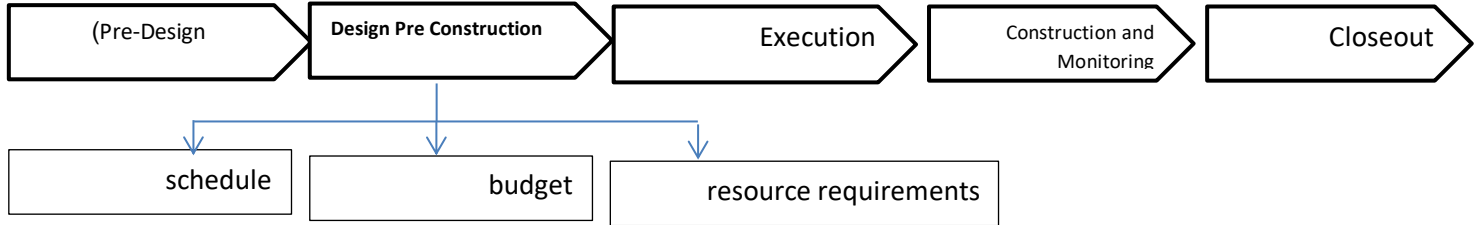

2- What type of building can use construction management? 4pts

- Residential home building and renovation
- Heavy industrial construction
- Commercial and institutional construction
- Engineering construction

3- Fill in the blanks with appropriate words (5pts)

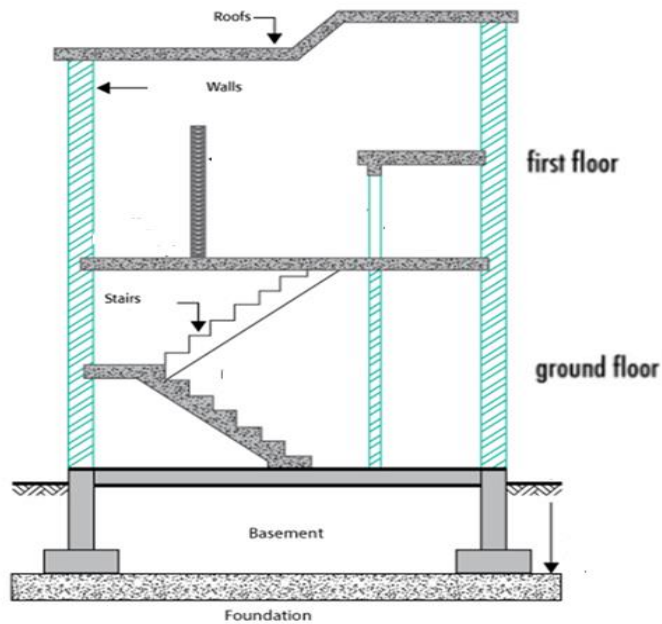

4- Complete the table? 4

Educational facilities	Entertainment facilities	medical facilities
<ul style="list-style-type: none"> - School - university..... 	<ul style="list-style-type: none"> - Park/...swimming pool..... - ...Hotels/Restaurants/..... 	<ul style="list-style-type: none"> - hospital/...clinics/emergency rooms laboratories.....